

INEX>EXPRESS™

TIMBER OR STEEL FRAME WITH HORIZONTAL SHEETS : FRL 60/60/60 & BAL-FZ

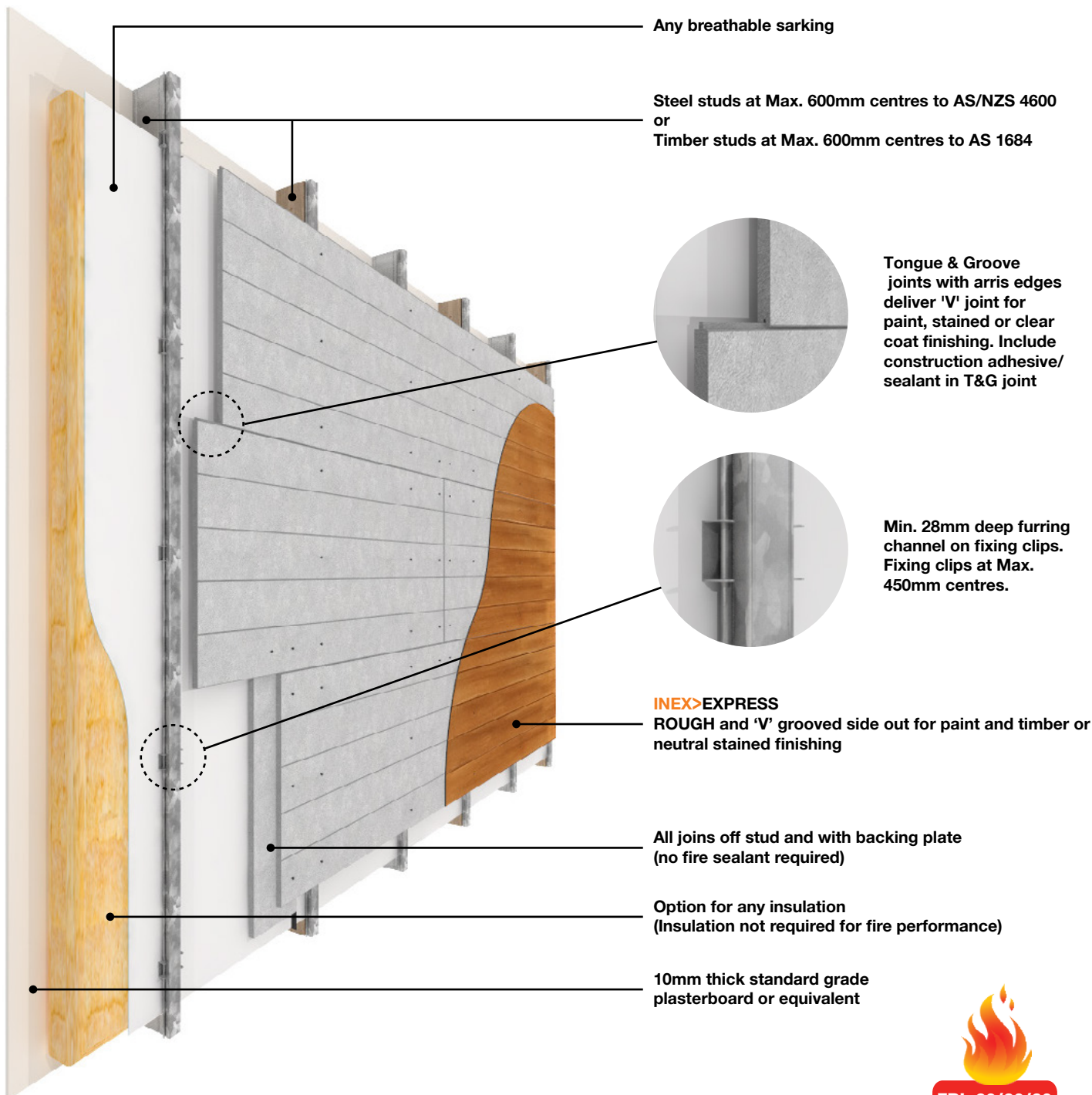

Achieves FRL 60/60/60 from outside only when tested to AS 1530.4-2014
Meets AS 3959-2018 Section 9 (BAL-FZ) via testing to AS 1530.4-2014



INEX>BOARDS™
FLOORING & CLADDING SOLUTIONS

INEX > EXPRESS™

TIMBER OR STEEL FRAME WITH HORIZONTAL SHEETS : FRL 60/60/60 & BAL-FZ

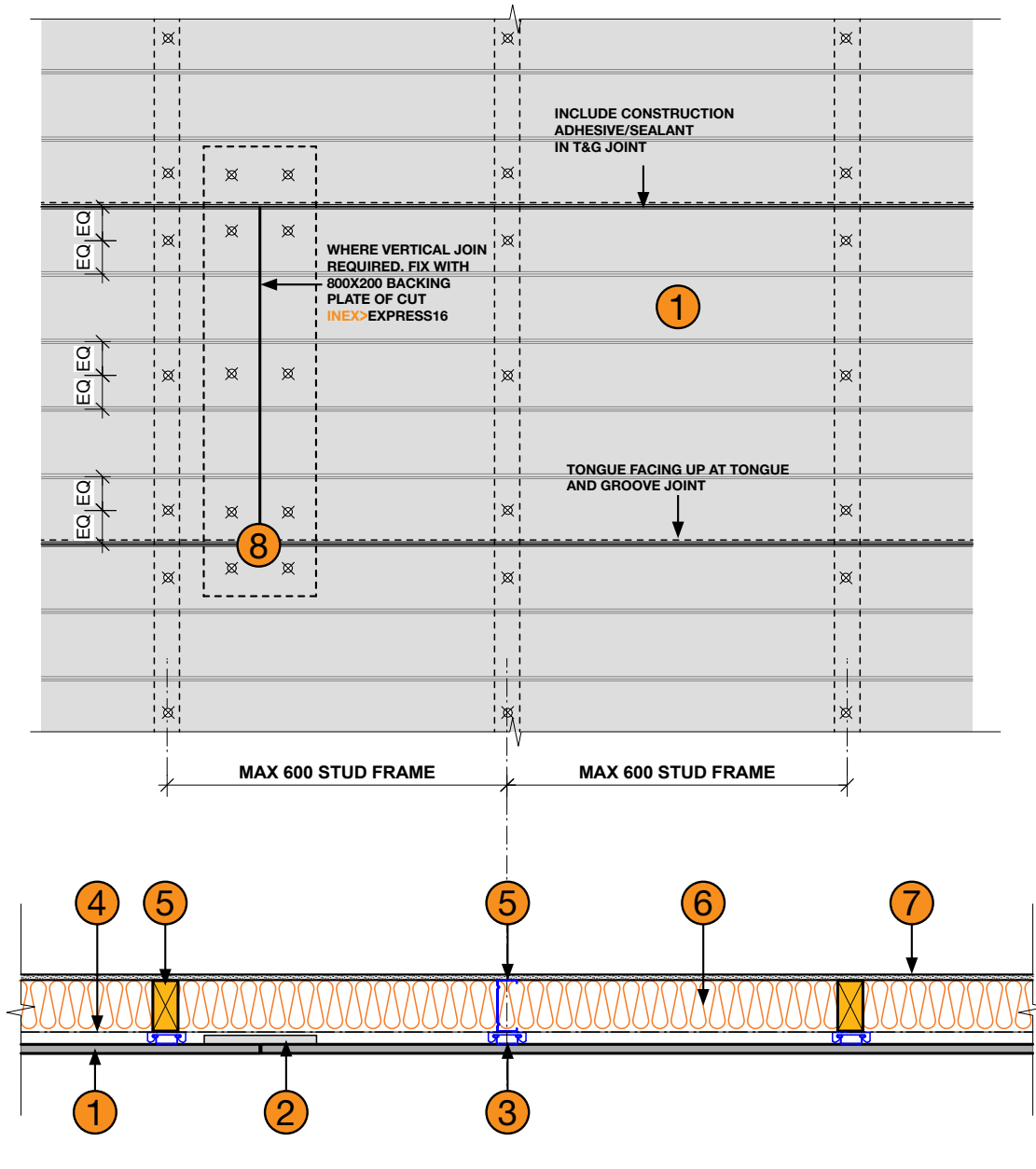

- | | |
|--|--|
| <p>1 INEX > EXPRESS16</p> <p>2 800x200 Backing plate
(Cut from INEX > BOARDS)</p> <p>3 Min. 28mm steel furring channel, on proprietary fixing clips. Fixing clips at Max. 450mm centres.</p> <p>4 Any breathable sarking</p> | <p>5 Steel studs at Max. 600mm centres to AS/NZS 4600 or Timber studs at Max. 600mm centres to AS 1684 (Both drawn)</p> <p>6 Any insulation (Insulation not required for fire performance)</p> <p>7 10mm thick standard grade plasterboard or equivalent</p> <p>8 10g Min. class 3 galvanised self driller counter sinking screws
BREMICK SWRC3100352
or
BREMICK vortexfibre SURC3500302</p> |
|--|--|

NOTES

Refer also to INEX > EXPRESS Technical Sheet for fixing details